

cobetter[®]

extruPro™ 系列 PVDF 管件

PVDF-HP 产品型录



extruPro™系列PVDF管件

应用于半导体超纯水供应系统

半导体制造中，需要使用大量的超纯水。而超纯水供应系统离不开管道和接头，由于工艺中对超纯水的金属离子、TOC、电阻率要求非常高，目前传输超纯水的材质主要是聚偏二氟乙烯 (PVDF)，聚偏二氟乙烯作为热塑性塑料有如下优点：

- 易加工性
- 焊接性好
- 非常好的耐化学腐蚀性，即使用在高温下
- 抗紫外线和γ-射线能力强，耐老化性好
- 出色的耐磨性 (低摩擦系数)
- 良好的力学性能
- 不含任何添加剂
- 出色的绝缘性能 (可以稳定地保证超纯水的电阻率超过18MΩcm)

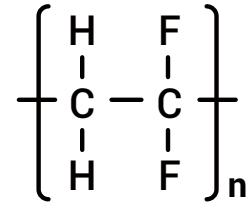

PVDF 化学结构

产品已顺利通过第三方 Semi F57 测试

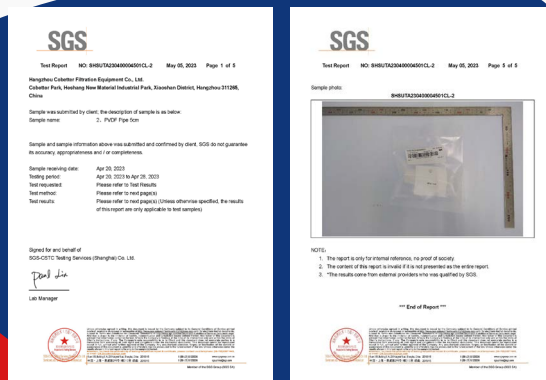

extruPro™系列 PVDF 管件

材质	PVDF HP (高纯)
颜色	本色
密度	1.78 g/cm ³ (ISO 1183/ASTM D792)
表面张力	30-35 mJ/m ²
表面电阻率	5 x 10 ¹⁴ Ωcm (IEC 60093)
尺寸	OD20 - 225mm (ISO 10931)
压力等级	PN10 & PN16
温度范围	-20 °C to +140 °C (-4 °F to +284°F)
生产工艺	接头--注塑工艺
	直管--挤出工艺
	车间洁净等级--千级
表面粗糙度	符合Semi F57标准: 直管 (<250 mm OD) ≤ 0.25μm 接头 (<250 mm OD) ≤ 0.35μm

洁净等级	符合Semi F57标准
产品标记	所有产品上都会激光打印上相应信息: - 生产日期 - 批次号 - 材质
	- 尺寸规格 - 压力等级 - 产品编码
焊接技术	非接触式红外热熔焊接 (DVS 2207)
产品包装	无尘车间 洁净包装
标签信息	品牌名
	- 生产日期 - 产品种类 - 产品编码
	- 材质 - 尺寸规格 - 压力等级



管道

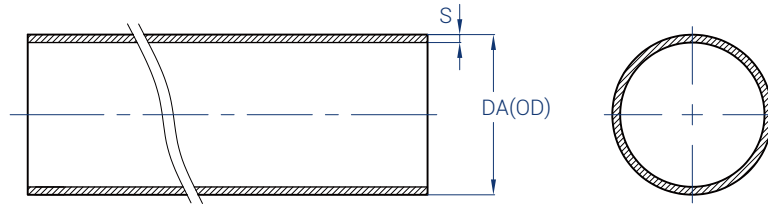

压力等级	尺寸 (mm)	编码	说明 Detail	DA(OD) (mm)	S (mm)	重量 (kg)
PN16	20	PV00102021	20×1.9 SDR21 ISO S-10	20.0	1.9	0.21
	25	PV00102521	25×1.9 SDR21 ISO S-10	25.0	1.9	0.27
	32	PV00103221	32×2.4 SDR21 ISO S-10	32.0	2.4	0.44
	40	PV00104021	40×2.4 SDR21 ISO S-10	40.0	2.4	0.55
	50	PV00105021	50×3.0 SDR21 ISO S-10	50.0	3.0	0.85
	63	PV00106321	63×3.0 SDR21 ISO S-10	63.0	3.0	1.09
	75	PV00107521	75×3.6 SDR21 ISO S-10	75.0	3.6	1.55
	90	PV00109021	90×4.3 SDR21 ISO S-10	90.0	4.3	2.22
	110	PV00111021	110×5.3 SDR21 ISO S-10	110.0	5.3	3.32
	125	PV00112521	125×6.0 SDR21 ISO S-10	125.0	6.0	4.24
	140	PV00114021	140×6.7 SDR21 ISO S-10	140.0	6.7	5.31
	160	PV00116021	160×7.7 SDR21 ISO S-10	160.0	7.7	6.96
	180	PV00118021	180×8.6 SDR21 ISO S-10	180.0	8.6	8.74
	200	PV00120021	200×9.6 SDR21 ISO S-10	200.0	9.6	10.74
225	PV00122521	225×10.8 SDR21 ISO S-10	225.0	10.8	13.67	
PN10	63	PV00106333	63×2.0 SDR33 ISO S-16	63.0	2.0	0.74
	75	PV00107533	75×2.3 SDR33 ISO S-16	75.0	2.3	1.01
	90	PV00109033	90×2.8 SDR33 ISO S-16	90.0	2.8	1.48
	110	PV00111033	110×3.4 SDR33 ISO S-16	110.0	3.4	2.20
	125	PV00112533	125×3.9 SDR33 ISO S-16	125.0	3.9	2.84
	140	PV00114033	140×4.3 SDR33 ISO S-16	140.0	4.3	3.52
	160	PV00116033	160×4.9 SDR33 ISO S-16	160.0	4.9	4.54
	180	PV00118033	180×5.5 SDR33 ISO S-16	180.0	5.5	5.74
	200	PV00120033	200×6.2 SDR33 ISO S-16	200.0	6.2	7.19
225	PV00122533	225×6.9 SDR33 ISO S-16	225.0	6.9	8.95	

90° 弯管

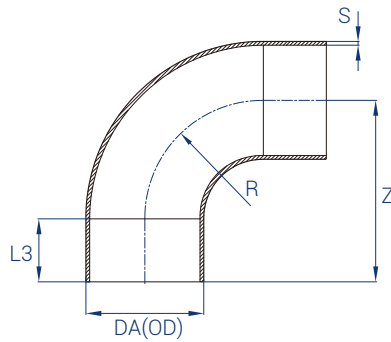

压力等级	尺寸 (mm)	编码	DA(OD) (mm)	S (mm)	Z (mm)	R (mm)	L3 (mm)	重量 (kg)
PN16	● 20	PV00302021I	20.0	1.9	51.0	20.0	33.0	0.02
	● 25	PV00302521I	25.0	1.9	56.0	25.0	33.0	0.02
	● 32	PV00303221I	32.0	2.4	63.0	32.0	33.0	0.05
	● 40	PV00304021I	40.0	2.4	72.0	40.0	36.0	0.07
	● 50	PV00305021I	50.0	3.0	84.0	50.0	36.0	0.13
	● 63	PV00306321I	63.0	3.0	97.0	63.0	34.0	0.20
	● 75	PV00307521I	75.0	3.6	100.0	75.0	28.0	0.29
	● 90	PV00309021I	90.0	4.3	123.0	90.0	34.0	0.52
	○ 110	PV00311021I	110.0	5.3	142.0	110.0	34.0	0.91
	○ 140	PV00314021I	140.0	6.7	216.0	140.0	73.0	2.02
PN10	○ 160	PV00316021I	160.0	7.7	236.0	160.0	73.0	2.84
	○ 225	PV00322521I	225.0	10.8	301.0	225.0	73.0	7.25
	● 90	PV00309033I	90.0	2.8	123.0	90.0	34.0	0.38
	● 110	PV00311033I	110.0	3.4	142.0	110.0	34.0	0.66
	● 140	PV00314033I	140.0	4.3	216.0	140.0	73.0	1.42
	● 160	PV00316033I	160.0	4.9	236.0	160.0	73.0	1.98
	● 225	PV00322533I	225.0	6.9	301.0	225.0	73.0	5.08

注：● 所代表尺寸可以正常下单

○ 所代表尺寸详情咨询科百特销售人员

45° 弯管

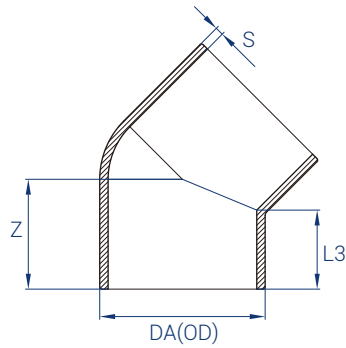

压力等级	尺寸 (mm)	编码	DA(OD) (mm)	S (mm)	Z (mm)	L3 (mm)	重量 (kg)
PN16	○ 20	PV00202021I	20.0	1.9	43.0	39.0	0.02
	○ 25	PV00202521I	25.0	1.9	45.0	40.0	0.02
	● 32	PV00203221I	32.0	2.4	52.0	46.0	0.05
	● 40	PV00204021I	40.0	2.4	58.0	50.0	0.07
	● 50	PV00205021I	50.0	3.0	66.0	56.0	0.11
	● 63	PV00206321I	63.0	3.0	75.0	62.0	0.17
	● 75	PV00207521I	75.0	3.6	50.0	32.0	0.15
	○ 90	PV00209021I	90.0	4.3	59.0	36.0	0.24
	○ 110	PV00211021I	110.0	5.3	68.0	45.0	0.44
	○ 140	PV00214021I	140.0	6.7	85.0	57.0	1.00
PN10	○ 160	PV00216021I	160.0	7.7	103.0	65.0	1.45
	○ 90	PV00209033I	90.0	2.8	59.0	36.0	0.17
	○ 110	PV00211033I	110.0	3.4	68.0	45.0	0.31
	○ 140	PV00214033I	140.0	4.3	85.0	57.0	0.63
	○ 160	PV00216033I	160.0	4.9	103.0	65.0	0.99

100mm 加长 45°弯管

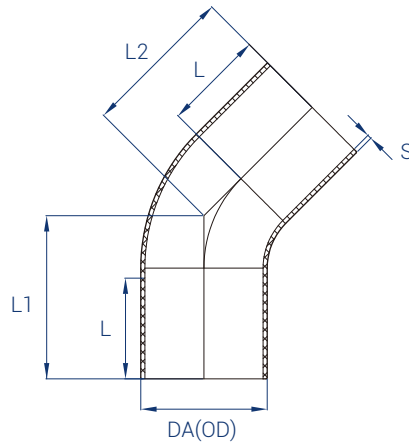

压力等级	尺寸 (mm)	编码	DA(OD) (mm)	S (mm)	L (mm)	L1 (mm)	L2 (mm)	重量 (kg)
PN16	○ 125	PV002L12521I	125.0	6.0	100.0	162.0	152.0	1.32
	○ 180	PV002L18021I	180.0	8.6	100.0	197.0	172.0	3.18
	○ 200	PV002L20021I	200.0	9.6	100.0	202.0	181.0	4.05
	○ 225	PV002L22521I	225.0	10.8	100.0	211.0	193.0	5.41
PN10	○ 125	PV002L12533I	125.0	3.9	100.0	162.0	152.0	0.70
	○ 180	PV002L12533I	180.0	5.5	100.0	197.0	172.0	2.15
	○ 200	PV002L20033I	200.0	6.2	100.0	202.0	181.0	2.82
	○ 225	PV002L22533I	225.0	6.9	100.0	211.0	193.0	3.76

注：● 所代表尺寸可以正常下单

○ 所代表尺寸详情咨询科百特销售人员

同心异径

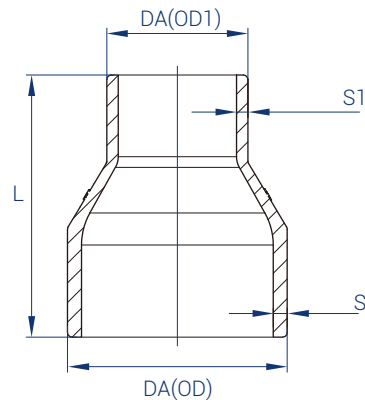

压力等级	尺寸 (mm)	编码	DA(OD/OD1) (mm)	S (mm)	S1 (mm)	L (mm)	重量 (kg)
PN16	○ 025/020	PV005025/020211	025/020	1.9	1.9	50.0	0.01
	● 032/020	PV005032/020211	032/020	2.4	1.9	50.0	0.02
	● 032/025	PV005032/025211	032/025	2.4	1.9	50.0	0.02
	○ 040/020	PV005040/020211	040/020	2.4	1.9	55.0	0.02
	○ 040/025	PV005040/025211	040/025	2.4	1.9	55.0	0.03
	● 040/032	PV005040/032211	040/032	2.4	2.4	55.0	0.03
	○ 050/020	PV005050/020211	050/020	3.0	1.9	60.0	0.04
	○ 050/025	PV005050/025211	050/025	3.0	1.9	60.0	0.04
	● 050/032	PV005050/032211	050/032	3.0	2.4	60.0	0.04
	○ 050/040	PV005050/040211	050/040	3.0	2.4	60.0	0.04
	○ 063/025	PV005063/025211	063/025	3.0	1.9	75.0	0.07
	● 063/032	PV005063/032211	063/032	3.0	2.4	65.0	0.06
	● 063/040	PV005063/040211	063/040	3.0	2.4	65.0	0.07
	● 063/050	PV005063/050211	063/050	3.0	3.0	65.0	0.06
	○ 075/050	PV005075/050211	075/050	3.6	3.0	148.0	0.20
	● 075/063	PV005075/063211	075/063	3.6	3.0	149.0	0.21
	○ 090/050	PV005090/050211	090/050	4.3	3.0	90.0	0.15
	● 090/063	PV005090/063211	090/063	4.3	3.0	160.0	0.27
	● 090/075	PV005090/075211	090/075	4.3	3.6	162.0	0.31
	● 110/063	PV005110/063211	110/063	5.3	3.0	103.0	0.23
	● 110/090	PV005110/090211	110/090	5.3	4.3	90.0	0.23
	○ 140/063	PV005140/063211	140/063	6.7	3.0	133.0	0.50
	● 140/110	PV005140/110211	140/110	6.7	5.3	110.0	0.48
● 160/110	PV005160/110211	160/110	7.7	5.3	230.0	1.30	
● 160/140	PV005160/140211	160/140	7.7	6.7	226.0	1.42	
PN10	○ 225/160	PV005225/160211	225/160	10.8	7.7	160.0	1.68
	● 110/063	PV005110/063331	110/063	3.4	3.0	103.0	0.21
	○ 110/090	PV005110/090331	110/090	3.4	2.8	90.0	0.20
	○ 140/110	PV005140/110331	140/110	4.3	3.5	110.0	0.35
	● 160/110	PV005160/110331	160/110	4.9	3.4	230.0	0.9
	● 160/140	PV005160/140331	160/140	4.9	4.3	226.0	1.02
	● 225/160	PV005225/160331	225/160	6.9	4.9	160.0	1.21
PN16/ PN10	● 090/063	PV005090/063311	090/063	2.8	3.0	160.0	0.25
	● 110/063	PV005110/063311	110/063	3.4	3.0	103.0	0.21
	● 160/110	PV005160/110311	160/110	4.9	5.3	230.0	1.17
	● 225/110	PV005225/110311	225/110	7.1	5.5	160.0	1.53
● 225/160	PV005225/160311	225/160	10.8	7.7	160.0	1.68	

注：● 所代表尺寸可以正常下单

○ 所代表尺寸详情咨询科百特销售人员

正三通

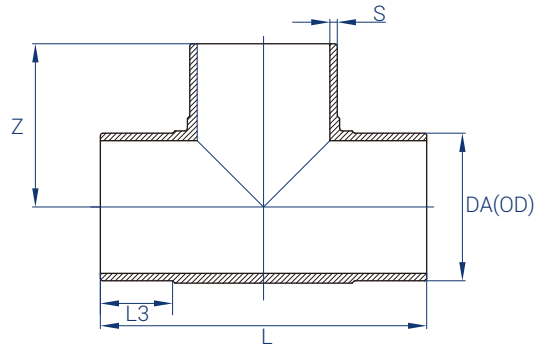

压力等级	尺寸 (mm)	编码	DA(OD) (mm)	S (mm)	Z (mm)	L (mm)	L3 (mm)	重量 (kg)
PN16	○ 20	PV00402021I	20.0	1.9	38.0	75.0	25.0	0.02
	○ 25	PV00402521I	25.0	1.9	42.0	84.0	25.0	0.03
	● 32	PV00403221I	32.0	2.4	46.0	90.0	25.0	0.05
	● 40	PV00404021I	40.0	2.4	58.0	116.0	31.0	0.08
	● 50	PV00405021I	50.0	3.0	64.0	126.0	31.0	0.15
	● 63	PV00406321I	63.0	3.0	70.0	140.0	31.0	0.23
	● 75	PV00407521I	75.0	3.6	89.0	178.0	42.0	0.38
	● 90	PV00409021I	90.0	4.3	92.0	185.0	33.5	0.62
	○ 110	PV00411021I	110.0	5.3	110.0	221.0	33.5	1.15
	○ 125	PV00412521I	125.0	6.0	139.0	279.0	52.0	1.65
	○ 140	PV00414021I	140.0	6.7	154.0	308.0	60.0	2.27
	○ 160	PV00416021I	160.0	7.7	140.0	279.0	45.0	2.64
	○ 180	PV00418021I	180.0	8.6	200.0	400.0	80.0	4.68
	○ 200	PV00420021I	200.0	9.6	223.0	446.0	89.0	7.09
○ 225	PV00422521I	225.0	10.8	246.0	496.0	99.0	9.30	
PN10	● 90	PV00409033I	90.0	2.8	92.0	185.0	33.5	0.47
	● 110	PV00411033I	110.0	3.4	110.0	221.0	33.5	0.87
	○ 125	PV00412533I	125.0	3.9	139.0	279.0	52.0	0.90
	● 140	PV00414033I	140.0	4.3	154.0	308.0	60.0	1.72
	● 160	PV00416033I	160.0	4.9	140.0	279.0	45.0	1.92
	○ 180	PV00418033I	180.0	5.5	200.0	400.0	80.0	3.28
	○ 200	PV00420033I	200.0	6.2	223.0	446.0	89.0	5.53
● 225	PV00422533I	225.0	6.9	246.0	496.0	99.0	6.72	

注：● 所代表尺寸可以正常下单

○ 所代表尺寸详情咨询科百特销售人员

加长三通

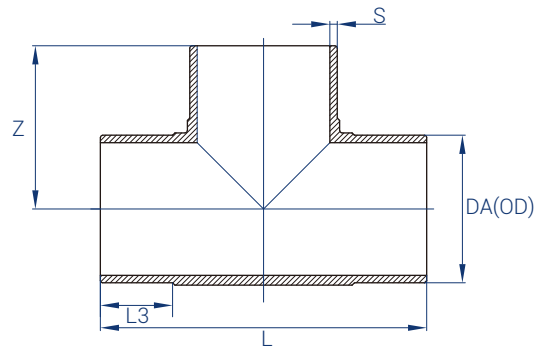

压力等级	尺寸 (mm)	编码	DA(OD) (mm)	S (mm)	Z (mm)	L (mm)	L3 (mm)	重量 (kg)
PN16	● 20	PV004L02021I	20.0	1.9	55.0	109.0	36.0	0.04
	● 25	PV004L02521I	25.0	1.9	59.0	117.0	40.0	0.06
	● 32	PV004L03221I	32.0	2.4	72.0	143.0	45.0	0.11

异径三通

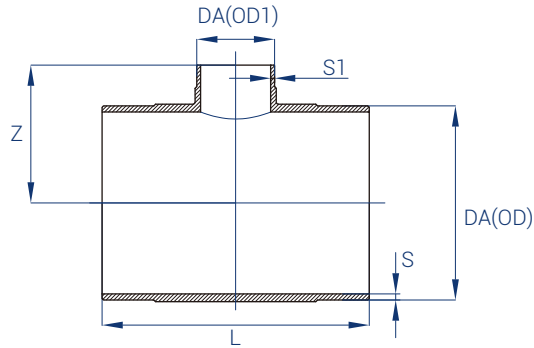

压力等级	尺寸 (mm)	编码	DA(OD/OD1) (mm)	S (mm)	S1 (mm)	Z (mm)	L (mm)	重量 (kg)
PN16	○ 63/20	PV009R063/020211	63/20	3.0	1.9	75.0	150.0	0.21
	○ 63/25	PV009R063/025211	63/25	3.0	1.9	75.0	150.0	0.21
	● 63/32	PV009R063/032211	63/32	3.0	2.4	74.0	149.0	0.21
	● 63/40	PV009R063/040211	63/40	3.2	2.6	70.5	117.0	0.33
	● 75/50	PV009R075/050211	75/50	3.8	3.2	69.0	130.0	0.55
	○ 90/63	PV009R090/063211	90/63	4.3	3.0	129.0	263.0	0.70
	● 110/63	PV009R110/063211	110/63	5.3	3.0	150.0	312.0	1.29
	○ 110/90	PV009R110/090211	110/90	5.3	4.3	150.0	313.0	1.37
	○ 160/63	PV009R160/063211	160/63	7.7	3.0	175.0	345.0	2.80
	○ 160/90	PV009R160/090211	160/90	7.7	4.3	183.0	348.0	3.21
PN16 / PN10	○ 160/110	PV009R160/110211	160/110	7.7	5.3	183.0	349.0	3.46
	○ 90/63	PV009R090/063311	90/63	2.8	3.0	129.0	263.0	0.58
	○ 110/63	PV009R110/063311	110/63	3.4	3.0	150.0	312.0	1.03
	○ 110/90	PV009R110/090311	110/90	3.4	2.8	150.0	313.0	1.15
	● 160/63	PV009R160/063311	160/63	4.9	3.0	175.0	345.0	2.06
	○ 160/90	PV009R160/090311	160/90	4.9	4.3	183.0	348.0	2.63
	○ 160/110	PV009R160/110311	160/110	4.9	5.3	183.0	349.0	2.95
PN10	● 225/110	PV009R225/110311	225/110	7.7	3.4	170.0	350.0	5.16
	○ 110/90	PV009R110/090331	110/90	3.4	2.8	150.0	313.0	1.07
	○ 160/63	PV009R160/063331	160/63	4.9	3.0	175.0	345.0	2.06
	● 160/90	PV009R160/090331	160/90	4.9	2.8	183.0	348.0	2.55
	● 160/110	PV009R160/110331	160/110	4.9	3.4	183.0	349.0	2.82
	● 225/90	PV009R225/090211	225/90	7.1	4.5	160.0	310.0	3.16
	● 225/160	PV009R225/160211	225/160	7.1	5.1	181.0	352.0	3.62

由令芯

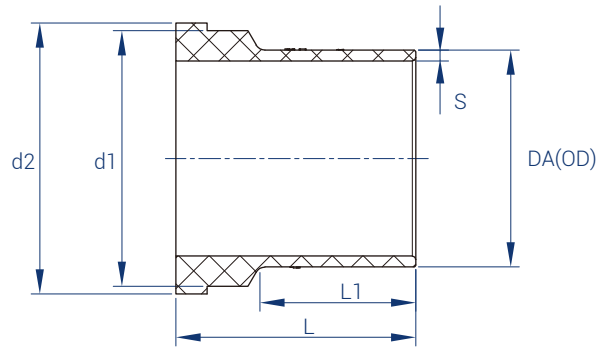

压力等级	尺寸 (mm)	编码	DA(OD) (mm)	S (mm)	L (mm)	L1 (mm)	d1 (mm)	d2 (mm)	重量 (kg)
PN16	● 20	PV01102021I	20.0	1.9	1.9	38.0	27.3	29.9	0.02
	● 25	PV01102521I	25.0	1.9	1.9	40.0	35.7	38.6	0.04
	● 32	PV01103221I	32.0	2.4	2.4	39.0	41.5	44.5	0.04
	● 40	PV01104021I	40.0	2.4	2.4	42.0	52.6	56.3	0.07
	● 50	PV01105021I	50.0	3.0	3.0	44.0	58.6	62.4	0.09
	● 63	PV01106321I	63.0	3.0	3.0	44.0	73.6	78.1	0.13
	○ 75	PV01107521I	75.0	3.6	3.6	37.0	90.0	101.0	0.21
	○ 90	PV01107521I	90.0	4.3	4.3	55.0	90.0	101.0	0.18

由令螺母

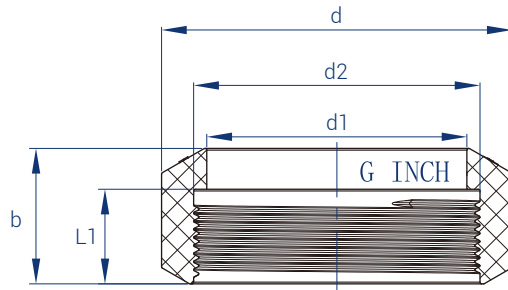

压力等级	尺寸 (mm)	编码	DA(OD) (mm)	螺纹	L1 (mm)	d (mm)	d1 (mm)	d2 (mm)	b (mm)	重量 (kg)
PN16	● 20	PV01202021I	20.0	G 1"	17.0	47.0	27.7	30.3	24.0	0.02
	● 25	PV01202521I	25.0	G 1 1/4"	18.5	57.0	36.1	39.0	26.0	0.05
	● 32	PV01203221I	32.0	G 1 1/2"	20.0	64.0	41.7	44.9	30.0	0.07
	● 40	PV01204021I	40.0	G 2"	22.5	76.5	53.2	56.7	31.0	0.09
	● 50	PV01205021I	50.0	G 2 1/4"	25.0	89.0	59.2	62.8	35.5	0.15
	● 63	PV01206321I	63.0	G 2 3/4"	27.0	109.0	74.2	78.5	39.0	0.23
	○ 75	PV01207521I	75.0	G 2 3/4"	31.0	130.0	90.7	102.1	40.0	0.29
	○ 90	PV01207521I	90.0	S 107.5*3.6	31.0	130.0	90.7	102.1	40.0	0.29

法兰盘一日标

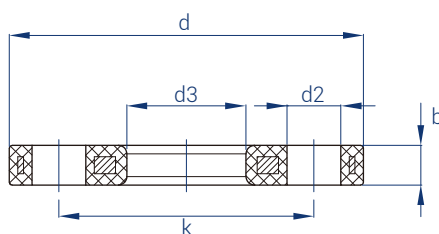

压力等级	尺寸 (mm)	编码	DA(OD) (mm)	d (mm)	d2 (mm)	d3 (mm)	b (mm)	k (mm)	重量 (kg)
PN16	○ 20	PG00702021I	20.0	96.0	15.0	28.0	12.0	70.0	0.25
	○ 25	PG00702521I	25.0	100.0	15.0	34.0	14.0	75.0	0.30
	● 32	PG00703221I	32.0	125.0	19.0	42.0	14.0	90.0	0.48
	○ 40	PG00704021I	40.0	135.0	19.0	51.0	14.0	100.0	0.54
	● 50	PG00705021I	50.0	140.0	19.0	62.0	16.0	105.0	0.63
	● 63	PG00706321I	63.0	159.0	19.0	78.0	16.0	120.0	0.75
	● 75	PG00707521I	75.0	175.0	19.0	92.0	16.0	139.0	0.90
	● 90	PG00709021I	90.0	185.0	19.0	110.0	18.0	150.0	0.85
	● 110/125	PG00711021I	110/125	210.0	19.0	133.0	18.0	175.0	0.99
	● 140	PG00714021I	140.0	250.0	23.0	158.0	20.0	210.0	1.55
	● 160	PG00716021I	160.0	280.0	22.0	178.0	22.0	240.0	2.53
	● 200/225	PG00722521I	200/225	330.0	23.0	238.0	22.0	290.0	2.56

法兰芯—日标

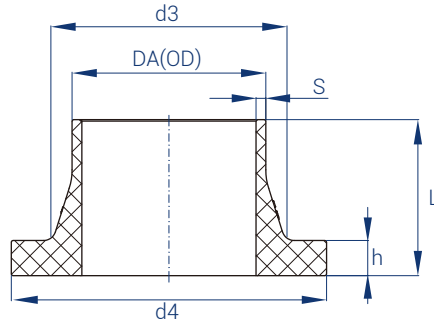

压力等级	尺寸 (mm)	编码	DA(OD) (mm)	S (mm)	L (mm)	d3 (mm)	d4 (mm)	h (mm)	重量 (kg)
PN16	○ 20	PV00602021I	20.0	1.9	49.0	27.0	45.0	6.0	0.03
	○ 25	PV00602521I	25.0	1.9	50.0	33.0	58.0	6.5	0.05
	● 32	PV00603221I	32.0	2.4	50.0	40.0	68.0	7.0	0.06
	○ 40	PV00604021I	40.0	2.4	50.0	50.0	78.0	8.0	0.08
	● 50	PV00605021I	50.0	3.0	50.0	61.0	84.0	9.0	0.13
	● 63	PV00606321I	63.0	3.0	50.0	76.0	99.0	10.0	0.17
	● 75	PV00607521I	75.0	3.6	50.0	89.0	119.0	10.0	0.21
	● 90	PV00609021I	90.0	4.3	80.0	105.0	129.0	11.0	0.37
	● 110	PV00611021I	110.0	5.3	80.0	125.0	154.0	12.0	0.52
	○ 125	PV00612521I	125.0	6.0	80.0	132.0	154.0	14.0	0.67
	● 140	PV00614021I	140.0	6.7	80.0	155.0	185.0	15.0	0.82
	● 160	PV00616021I	160.0	7.7	81.0	175.0	212.0	16.0	1.07
	○ 200	PV00620021I	200.0	9.6	100.0	232.0	265.0	20.0	2.40
	● 225	PV00622521I	225.0	10.8	100.0	235.0	265.0	20.0	1.83
PN10	○ 90	PV00609033I	90.0	2.8	80.0	105.0	129.0	11.0	0.38
	○ 110	PV00611033I	110.0	3.4	80.0	125.0	154.0	12.0	0.42
	○ 125	PV00612533I	125.0	3.9	80.0	132.0	154.0	14.0	0.52
	○ 140	PV00614033I	140.0	4.3	80.0	155.0	185.0	15.0	0.64
	○ 160	PV00616033I	160.0	4.9	81.0	175.0	212.0	16.0	0.98
	○ 200	PV00620033I	200.0	6.2	100.0	232.0	265.0	20.0	2.19
	○ 225	PV00622533I	225.0	6.9	100.0	235.0	265.0	20.0	1.40

注：● 所代表尺寸可以正常下单

○ 所代表尺寸详情咨询科百特销售人员

法兰芯—美标

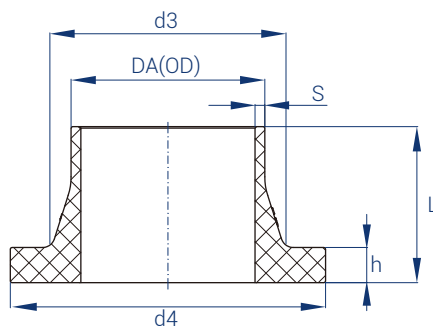

压力等级	尺寸 (mm)	编码	DA(OD) (mm)	S (mm)	L (mm)	d3 (mm)	d4 (mm)	h (mm)	重量 (kg)
PN16	○ 20	PV00602021A	20.0	1.9	49.0	27.0	44.5	6.0	0.03
	○ 25	PV00602521A	25.0	1.9	50.0	33.0	54.1	6.5	0.04
	● 32	PV00603221A	32.0	1.9	50.0	40.0	63.5	7.0	0.06
	○ 40	PV00604021A	40.0	1.9	50.0	50.0	71.5	8.0	0.09
	● 50	PV00605021A	50.0	1.9	50.0	61.0	82.6	9.0	0.12
	● 63	PV00606321A	63.0	1.9	50.0	76.0	100.4	10.0	0.17
	● 75	PV00607521A	75.0	1.9	50.0	89.0	117.0	10.0	0.22
	● 90	PV00609021A	90.0	1.9	80.0	105.0	132.4	11.0	0.37
	● 110	PV00611021A	110.0	1.9	80.0	125.0	158.0	12.0	0.56
	○ 125	PV00612521A	125.0	1.9	80.0	132.0	158.0	14.0	0.67
	● 160	PV00616021A	160.0	1.9	81.0	175.0	212.0	16.0	1.13
	○ 200	PV00620021A	200.0	1.9	100.0	232.0	268.0	20.0	2.26
	● 225	PV00622521A	225.0	1.9	100.0	235.0	268.0	24.0	1.92
	PN10	○ 90	PV00609033A	90.0	2.8	80.0	105.0	132.4	11.0
○ 110		PV00611033A	110.0	3.4	80.0	125.0	158.0	12.0	0.46
○ 125		PV00612533A	125.0	3.9	80.0	132.0	158.0	14.0	0.52
○ 160		PV00616033A	160.0	4.9	81.0	175.0	212.0	16.0	0.95
○ 200		PV00620033A	200.0	6.2	100.0	232.0	268.0	20.0	1.90
○ 225		PV00622533A	225.0	6.9	100.0	235.0	268.0	24.0	1.43

法兰芯—德标

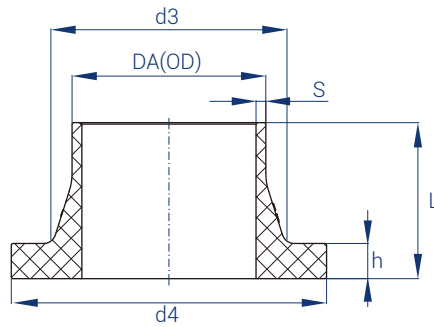

压力等级	尺寸 (mm)	编码	DA(OD) (mm)	S (mm)	L (mm)	d3 (mm)	d4 (mm)	h (mm)	重量 (kg)
PN16	○ 20	PV00602021D	20.0	1.9	49.0	27.0	45.0	6.0	0.03
	○ 25	PV00602521D	25.0	1.9	50.0	33.0	58.0	6.5	0.04
	● 32	PV00603221D	32.0	2.4	50.0	40.0	68.0	7.0	0.04
	○ 40	PV00604021D	40.0	2.4	50.0	50.0	78.0	8.0	0.09
	● 50	PV00605021D	50.0	3.0	50.0	61.0	88.0	9.0	0.13
	● 63	PV00606321D	63.0	3.0	50.0	76.0	102.0	10.0	0.17
	● 75	PV00607521D	75.0	3.6	50.0	89.0	122.0	10.0	0.23
	● 90	PV00609021D	90.0	4.3	80.0	105.0	138.0	11.0	0.40
	● 110	PV00611021D	110.0	5.3	80.0	125.0	158.0	12.0	0.54
	○ 125	PV00612521D	125.0	6.0	80.0	132.0	158.0	14.0	0.63
	● 140	PV00614021D	140.0	6.7	80.0	155.0	188.0	15.0	0.81
	● 160	PV00616021D	160.0	7.7	81.0	175.0	212.0	16.0	1.13
	○ 180	PV00618021D	180.0	8.6	80.0	183.0	212.0	18.0	1.07
	○ 200	PV00620021D	200.0	9.6	100.0	232.0	268.0	20.0	2.32
● 225	PV00622521D	225.0	10.8	100.0	235.0	268.0	20.0	1.95	
PN10	○ 90	PV00609033D	90.0	2.8	80.0	105.0	138.0	11.0	0.35
	○ 110	PV00611033D	110.0	3.4	80.0	125.0	158.0	12.0	0.46
	○ 125	PV00612533D	125.0	3.9	80.0	132.0	158.0	14.0	0.48
	○ 140	PV00614033D	140.0	4.3	80.0	155.0	188.0	15.0	0.68
	○ 160	PV00616033D	160.0	4.9	81.0	175.0	212.0	16.0	0.94
	○ 180	PV00618033D	180.0	5.5	80.0	183.0	212.0	18.0	0.85
	○ 200	PV00620033D	200.0	6.2	100.0	232.0	268.0	20.0	1.94
	○ 225	PV00622533D	225.0	6.9	100.0	235.0	268.0	20.0	1.55

注：● 所代表尺寸可以正常下单

○ 所代表尺寸详情咨询科百特销售人员

取样三通

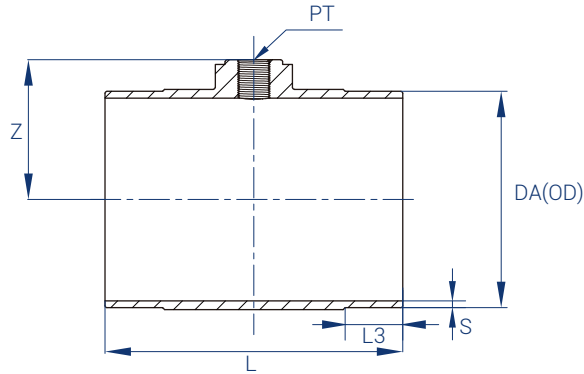

压力等级	尺寸 (mm)	取样螺纹 (PT)	编码	DA(OD) (mm)	S (mm)	Z (mm)	L (mm)	L3 (mm)	重量 (kg)
PN16	○ 50	3/8"	PV010050PT1I	50.0	3.0	58.0	126.0	30.0	0.21
	○ 63	3/8"	PV010063PT1I	63.0	3.0	64.5	139.0	30.0	0.32
	○ 75	3/8"	PV010075PT1I	75.0	3.6	70.5	178.0	42.0	0.44
	○ 90	3/8"	PV010090PT1I	90.0	4.3	78.0	180.0	50.0	0.53
	○ 110	3/8"	PV010110PT1I	110.0	5.3	88.0	180.0	50.0	0.79
	○ 140	3/8"	PV010140PT1I	140.0	6.7	103.0	180.0	50.0	1.19
	○ 140	1/2"	PV010140PT2I	140.0	6.7	103.0	180.0	50.0	1.25
	○ 140	3/4"	PV010140PT3I	140.0	6.7	103.0	180.0	50.0	1.23
	○ 140	1"	PV010140PT4I	140.0	6.7	103.0	180.0	50.0	1.20
	○ 160	3/8"	PV010160PT1I	160.0	7.7	113.0	180.0	50.0	1.50
	○ 160	1/2"	PV010160PT2I	160.0	7.7	113.0	180.0	50.0	1.52
	○ 160	3/4"	PV010160PT3I	160.0	7.7	113.0	180.0	50.0	1.60
	○ 160	1"	PV010160PT4I	160.0	7.7	113.0	180.0	50.0	1.56
	● 225	1"	PV010225PT4I	225.0	6.9	160.0	310.0	61.0	3.80

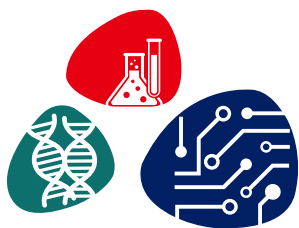

**Filtration
Separation
Purification**

cobetter[®]

Tel +86-571-87704266
Fax +86-571-87704256
www.cobetterfiltration.com

杭州科百特过滤器材有限公司
Hangzhou Cobetter Filtration Equipment Co.,Ltd.

地址：浙江省杭州市萧山区金城路39号 紫橙国际创新中心 1号楼 13-18层
厂址：浙江省杭州市萧山区河上新材料产业园科百特园区